

Vaaldam Nature Reserve

Declaration of reserve	8 September 1954	223, 1954



Proklamasies, Administrateurs- en Algemene Kennisgewings wat vir die eerste maal gepubliseer word, is in die linkerbohoek met 'n * gemerk.

All Proclamations, Administrator's and Miscellaneous Notices published for the first time, are indicated by a * in the left-hand upper corner.

* No. 223 (Administrateurs-), 1954.]

PROKLAMASIE

DEUR SY EDELE DIE ADMINISTRATEUR VAN DIE
PROVINSIE TRANSVAAL.

Nademaal daar by paragraaf (d) van artikel elf van die Wildordonnansie, 1949 (Ordonnansie No. 23 van 1949), soos gewysig, bepaal word dat die Administrateur van tyd tot tyd, na verwysing na die Raad van Advies insake Fauna en Flora, by proklamasie in die *Staatskoerant* 'n omskrewe gebied tot 'n wildreserwe kan verklaar;

En nademaal daar by paragraaf (a) van subartikel (2) van artikel twee van die Ordonnansie op die Beskerming van Inheemse Flora, 1940 (Ordonnansie No. 9 van 1940), soos gewysig, bepaal word dat die Administrateur van tyd tot tyd by proklamasie in die *Offisiële Koerant van die Provinsie Transvaal* een of meer reserwes vir inheemse flora kan instel.

So is dit dat ek, kragtens en ingevolge voornoemde bevoegdhede, en na verwysing na genoemde raad, hierby verklaar dat die gebiede in Bylae A by hierdie Proklamasie omskryf, voortaan wildreserwes en reserwes vir inheemse flora is waarop die bepalings van genoemde Ordonnansie van toepassing is, en dat genoemde reserwes bekend sal wees onder die onderskeidelike name soos in genoemde Bylae uiteengesit;

En ek verklaar voorts dat die Proklamasies in Bylae B by hierdie Proklamasie uiteengesit, hierby herroep word.

GOD BEHOEDE DIE KONINGIN.

Gegee onder my Hand te Pretoria, op hede die Sewentiende dag van Augustus Eenduisend Negehoenderd Vier-en-vyftig.

Wm. NICOL,
Administrateur van die Provinsie Transvaal.

F.F. 42.

BYLAE A.

BARBERSPAN-NATUURRESERVAAT, DISTRIK DELAREYVILLE.

(Grootte: Ongeveer 4,233 morges.)

Dié gedeeltes van die plaas Vergenoeg No. 52, Barberspan No. 72, Groenfontein No. 71, Zandvlei No. 53 en Leeuwpan No. 22, distrik Delareyville, wat bedek of omring is deur die water van die pan bekend as Barberspan, en 'n gebied een myl wyd om genoemde pan, gemeet van die buitekant van genoemde waters af.

A-301789

* No. 223 (Administrator's), 1954.]

PROCLAMATION

BY THE HONOURABLE THE ADMINISTRATOR OF THE
PROVINCE OF TRANSVAAL.

Whereas it is provided in paragraph (d) of section eleven of the Game Ordinance, 1949 (Ordinance No. 23 of 1949), as amended, that the Administrator may, from time to time after reference to the Fauna and Flora Advisory Board, by proclamation in the *Gazette*, declare any defined area to be a game reserve;

And whereas it is provided in paragraph (a) of subsection (2) of section two of the Native Flora Protection Ordinance, 1940 (Ordinance No. 9 of 1940), as amended, that the Administrator may from time to time by proclamation in the *Provincial Gazette of the Province of Transvaal* established one or more native flora reserves;

Now, therefore, under and by virtue of the aforesaid powers, and after reference to the said board, I do hereby declare that the areas defined in Schedule A to this Proclamation shall henceforth be game reserves and native flora reserves, to which the provisions of the said Ordinance shall apply, and that the said reserves shall be known by the respective names set out in the said Schedule;

And, I do further declare that the Proclamations set out in Schedule B to this Proclamation are hereby repealed.

GOD SAVE THE QUEEN.

Given under my Hand at Pretoria on this Seventeenth day of August, One thousand Nine hundred and Fifty-four.

Wm. NICOL,
Administrator of the Province of Transvaal.

F.F. 42.

SCHEDULE A.

BARBERSPAN NATURE RESERVE, DISTRICT DELAREYVILLE.

(Size: Approximately 4,233 morges.)

Those portions of the farms Vergenoeg No. 52, Barberspan No. 72, Groenfontein No. 71, Zandvlei No. 53 and Leeuwpan No. 22, District Delareyville which are submerged under or surrounded by the waters of the pan known as Barberspan and an area one mile wide around the said pan and measured from the outer edge of the said waters.

grens en met inbegrip van Gedeelte No. 15 van die suidelike gedeelte van die plaas Panfontein No. H.O. 270 tot by die noordwestelike baken daarvan; daarvandaan in 'n noordwestelike rigting langs die westelike grens en met inbegrip van Gedeelte C van die plaas Panfontein No. H.O. 270 tot by die noordwestelike baken daarvan; daarvandaan in 'n noordoostelike rigting langs die noordelike grens en met inbegrip van Gedeeltes C en B van die plaas Panfontein No. H.O. 270 tot by die noordoostelike baken van laasgenoemde gedeelte; daarvandaan in 'n suidoostelike rigting langs die oostelike grens en met inbegrip van Gedeelte B van die plaas Panfontein No. H.O. 270 tot by die suidoostelike baken daarvan; daarvandaan in 'n oostelike rigting langs die noordoostelike grens en met inbegrip van Gedeelte No. 3 van Gedeelte A van die plaas Boschpan No. H.O. 339 tot by die suidoostelike baken daarvan; daarvandaan in 'n westelike rigting langs die suidelike grens en met inbegrip van Gedeelte No. 3 van Gedeelte A van die plaas Boschpan No. H.O. 339, die resterende gedeelte van die plaas Boschpan No. H.O. 339, 'n gedeelte van die plaas Boschpan No. H.O. 339 en die restant van die plaas Boschpan No. H.O. 339 tot by die suidwestelike baken van laasgenoemde eiendom; daarvandaan in 'n suidoostelike rigting langs die oostelike grens en met inbegrip van Gedeelte A van die suidelike gedeelte van die plaas Panfontein No. H.O. 270 tot by die suidoostelike baken daarvan; daarvandaan in 'n suidwestelike rigting langs die suidelike grens en met inbegrip van Gedeelte A van die suidelike gedeelte van die plaas Panfontein No. H.O. 270 tot by die suidwestelike baken daarvan, die aanvangspunt.

H.O. 270, thence in a northerly direction along the western boundary of and including Portion No. 13 of the southern portion of the farm Panfontein No. H.O. 270 to the north-western beacon thereof; thence in a north-westerly direction along the western boundary of and including Portion C of the farm Panfontein No. H.O. 270 to the north-western beacon thereof; thence in a north-easterly direction along the northern boundary of and including Portions C and B of the farm Panfontein No. 270 to the north-eastern beacon of the last-named portion; thence in a south-easterly direction along the eastern boundary of and including Portion B of the farm Panfontein No. H.O. 270 to the south-eastern beacon thereof; thence in an easterly direction along the north-eastern boundary of and including Portion No. 3 of Portion A of the farm Boschpan No. H.O. 339 to the south-eastern beacon thereof; thence in a westerly direction along the southern boundary of and including Portion No. 3 of Portion A of the farm Boschpan No. H.O. 339, the remaining extent of the farm Boschpan No. H.O. 339, a portion of the farm Boschpan No. H.O. 339 and the remainder of the farm Boschpan No. H.O. 339 to the south-western beacon of the last-named property; thence in a south-easterly direction along the eastern boundary of and including Portion A of the southern portion of the farm Panfontein No. H.O. 270 to the south-eastern beacon thereof; thence in a south-westerly direction along the southern boundary of and including Portion A of the southern portion of the farm Panfontein No. H.O. 270 to the south-western beacon thereof, the starting point.

S A. LOMBARD NATUURRESERVAAT
S A. LOMBARD NATURE RESERVE.

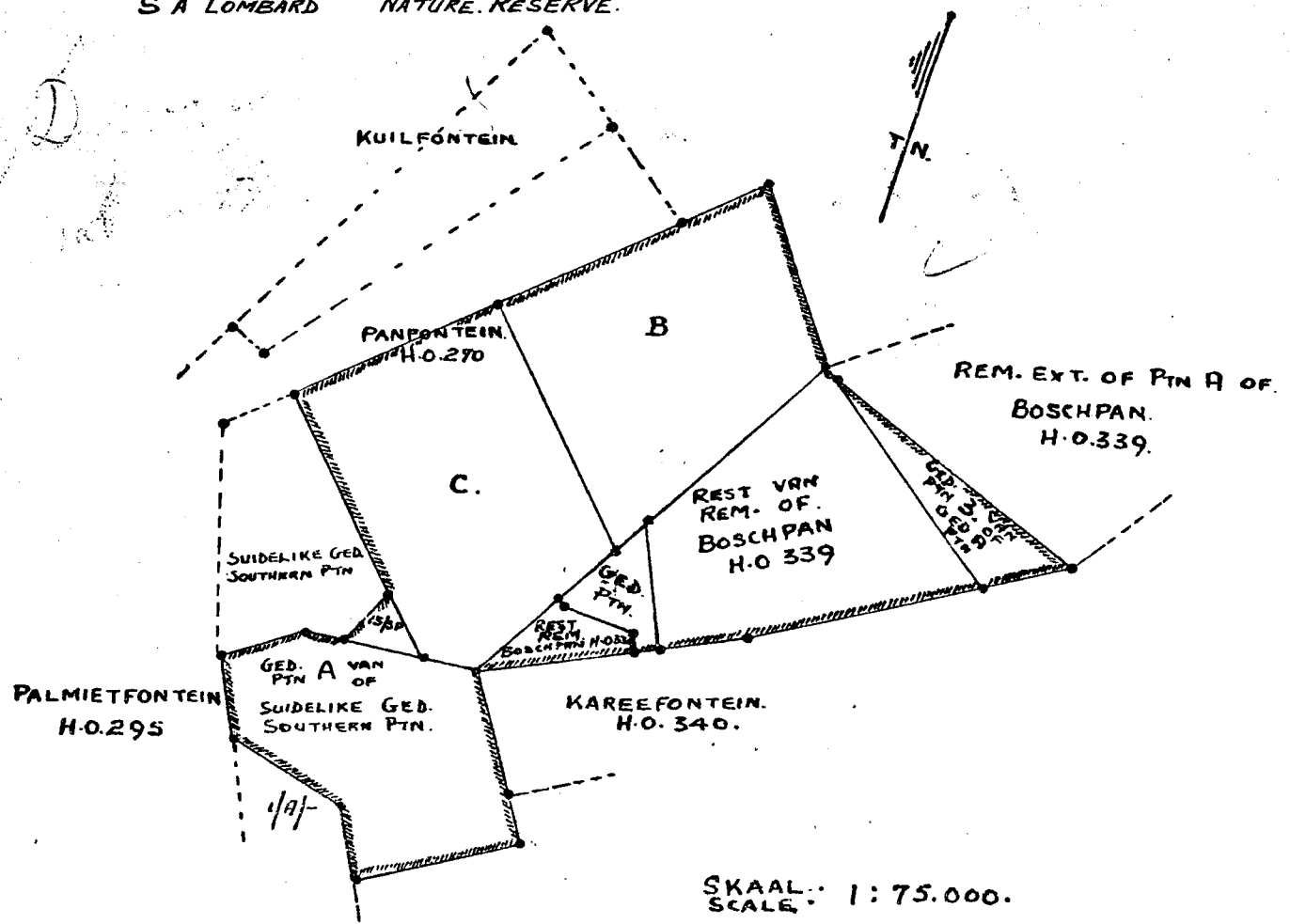

SKAAL: 1:75.000.
 SCALE: 1:75.000.

VAALDAM-NATUURRESERVAAT, DISTRIKTE
VEREENIGING EN HEIDELBERG.

(Grootte: Ongeveer 29,976 morges.)

Beginnende by die noordwestelike baken van Gedeelte C van die plaas Vaalbank No. 101, magistraatsdistrik Vereeniging; vandaar ooswaarts, noordwaarts, ooswaarts,

VAALDAM NATURE RESERVE, DISTRICTS
VEREENIGING AND HEIDELBERG.

(Size: Approximately 29,976 morgen.)

Beginning at the north-western beacon of Portion C of the farm Vaalbank No. 101, Magisterial District Vereeniging; thence eastwards, northwards, eastwards,

suidwaarts en suidooswaarts langs die grense en met inbegrip van die volgende plase: Gedeelte C en B van Vaalbank No. 101, Gedeelte van Vaalbank No. 101, Kaart No. A.1339/05, restant van gedeelte van Vaalbank No. 101, Kaart No. A.5196/04, gedeeltes van Hartebeestfontein No. 98, Kaarte Nos. A.5980/04 en A.877/05, A.87805 en A.4/05, restant van Stryfontein No. 100, Gedeelte A van Stryfontein No. 100, Knoppiesfontein No. 298, Heidelberg-magistraatsdistrik, gedeelte van Vaalriviersdraai No. 237, gedeelte van Boschkop No. 253, Gedeelte E, Klipbult van Boschkop No. 253, Gedeelte No. 1 van A van Zandfontein No. 20, gedeelte van Boschkop No. 253, gedeelte van Vaalriviersdraai No. 237, restant van gedeelte Vaalriviersdraai No. 237, restant van Gedeelte A, Zandfontein No. 20, Gedeeltes B, C en D van Zandfontein No. 20, Zandfontein No. 171, Gedeeltes E, F, G en resterende gedeelte van Zandfontein No. 20, Gedeeltes Nos. 4, 7, 6 en resterende gedeelte van Draaifontein No. 278, Gedeelte No. 1, genoem De Hoop, Gedeelte No. 2 en die restant van gedeelte van Draaifontein No. 278, Gedeeltes A, E en B van Leeuwfontein No. 159, Gedeelte A en restant van Zandfontein No. 303, restant van Rietfontein No. 59, Gedeeltes D en E van Rietfontein No. 59, restant van C en Gedeelte No. 1 van C en Gedeelte A van Rietfontein No. 59, gedeeltes van Bothaskraal No. 300 soos op Kaarte Nos. A.365/91 tot A.368/91 aangetoon, restant van Bothaskraal No. 300 en Gedeelte K, genoem Vrededal, van Bothaskraal No. 300, restant van Gedeelte B van die westelike helfte van Rietfontein No. 151, Gedeeltes Nos. 1 van B, D, 2 van E, restant van F, 1 van F van westelike helfte van Rietfontein No. 151, restant van westelike helfte van Rietfontein No. 151 en restant van Gedeelte E van Rietfontein No. 151, Gedeeltes D, E en restant van oostelike gedeelte van Rietfontein No. 151, en vandaar in 'n westelike rigting langs die middel van Vaalrivier tot by die aanvangspunt.

southwards and south-eastwards along the boundaries of and including the following farms: Portions C and B of Vaalbank No. 101, Portion of Vaalbank No. 101 Diagram A. 1339/05, remainder of portion of Vaalbank No. 101, Diagram A. 5196/04, portions of Hartebeestfontein No. 98, Diagrams A. 5980/04 and A. 877/05, A. 878/05 and A. 4/05, remainder of Stryfontein No. 100, Portion A of Stryfontein No. 100, Knoppiesfontein No. 298, Heidelberg Magisterial District, portion of Vaalriviersdraai No. 237, portion of Boschkop No. 253, portion E Klipbult of Boschkop No. 253, Portion No. 1 of A of Zandfontein No. 20, portion of Boschkop No. 253, portion of Vaalriviersdraai No. 237, remainder of Portion Vaalriviersdraai No. 237, remainder of Portion A Zandfontein No. 20, Portions B, C and D of Zandfontein No. 20, Zandfontein No. 171, Portions E, F, G and remaining extent of Zandfontein No. 20, Portions Nos. 4, 7, 6 and remaining extent of Draaifontein No. 278, Portion No. 1, called De Hoop Portion No. 2 and the remainder of portion of Draaifontein No. 278, Portions A, E and B of Leeuwfontein No. 159, Portion A and remainder of Zandfontein No. 303, remainder of Rietfontein No. 59, Portions D and E of Rietfontein No. 59, remainder of C and Portion No. 1 of C and Portion A of Rietfontein No. 59, Portions of Bothaskraal No. 300 as indicated by Diagrams A. 365/91 to A. 368/91, Remainder of Bothaskraal No. 300 and Portion K called Vrededal of Bothaskraal No. 300, remainder of Portion B of the western half of Rietfontein No. 151, Portions Nos. 1 of B, D, 2 of E, remainder of F, 1 of F of western half of Rietfontein No. 151, remainder of western half of Rietfontein No. 151, and remainder of Portion E of Rietfontein No. 151, Portions D, E and remainder of eastern portion of Rietfontein No. 151, thence in a westerly direction along the centre of the Vaal River to the point of beginning.

VALDAM NATUURRESERVAT
VALDM. NATURE RESERVE

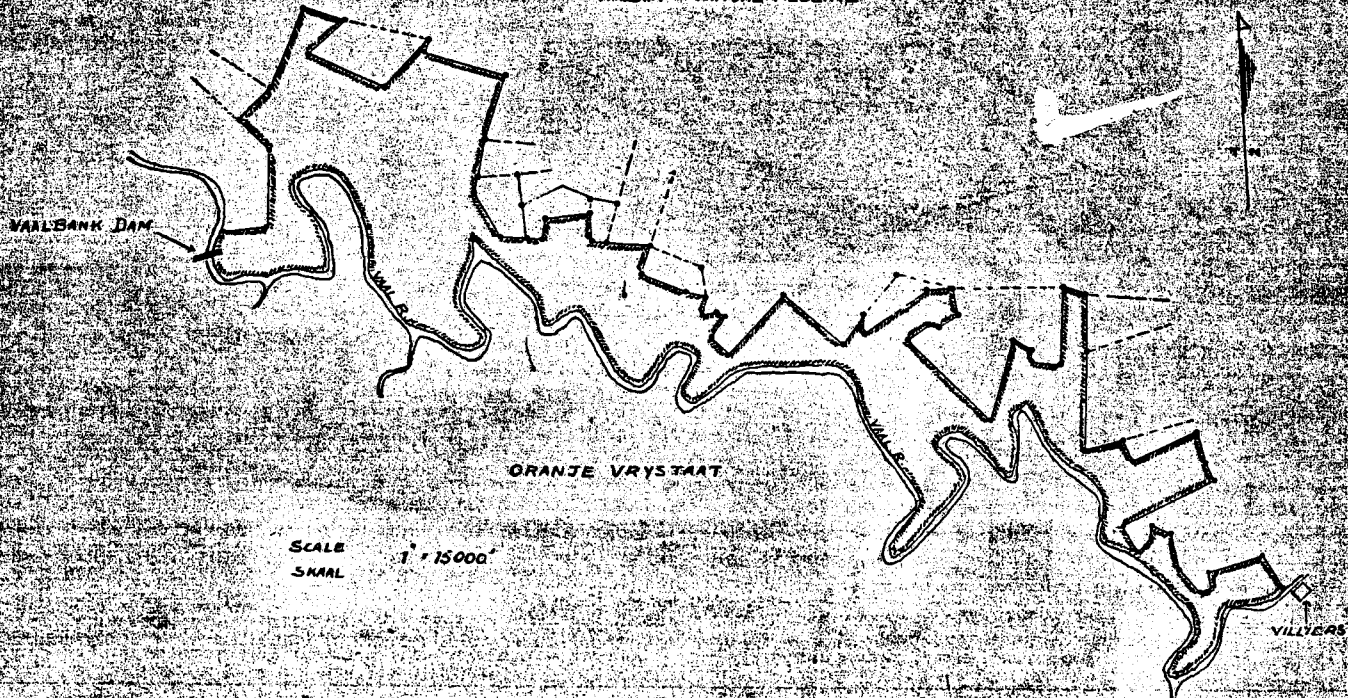

WESTDENEPAN-NATUURRESERVAAT, BENONI.

WESTDENE PAN NATURE RESERVE, DISTRICT BENONI.

(Grootte: 51·66229 morges.)

(Size: 51·66229 morgen.)

Bestaande uit: Erf No. 3660 in die dorp Benoni Westelike Uitbreiding No. 4, soos voorgestel op Algemene Plan L.G. No. A.3555/37.

Comprising Erf No. 3660 in the Township of Benoni Western Extension No. 4, as represented on General Plan L.G. No. A. 3555/37.